

5mm Blinking LEDs Series

Kingbright

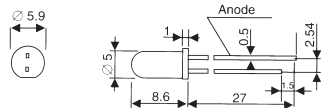

Part No.	Colour	Viewing Angle	Luminous Intensity [mcd@9V]	U_f [max.V/mA]
L-56 BSRD/B	red	60°	200	14/44
L-56 BHD	red	60°	200	14/44
L-56 BGD	green	60°	20	14/44
L-56 BYD	yellow	60°	20	14/44
L-56 BND	orange	60°	20	14/44

Part No.	Ord. No.
S L-56 BSRD/B	12507
S L-56 BHD	12199
S L-56 BGD	12374
S L-56 BYD	12375
S L-56 BND	12414

8mm Blinking LEDs Series

Kingbright

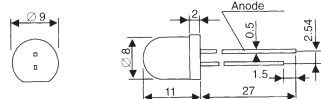

Part No.	Colour	Viewing Angle	Luminous Intensity [mcd@9V]	U_f [max.V/mA]
L-796 BID	red	60°	40	14/48
L-796 BGD	green	60°	50	14/44
L-796 BYD	yellow	60°	40	14/48

Part No.	Ord. No.
S L-796 BID	12303
O L-796 BGD	12508
O L-796 BYD	12509

10mm Blinking LEDs Series

Kingbright

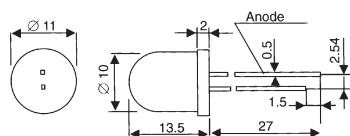

Part No.	Colour	Viewing Angle	Luminous Intensity [mcd@9V]	U_f [max.V/mA]
L-816 BID	red	60°	60	14/50
L-816 BGD	green	60°	50	
L-816 BYD	yellow	60°	40	

Part No.	Ord. No.
S L-816 BID	12256
O L-816 BGD	12376
O L-816 BYD	12334

Bi - Colour LEDs

3mm 2-Colour Series

Kingbright

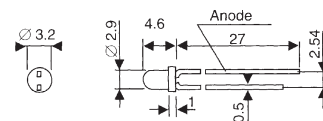
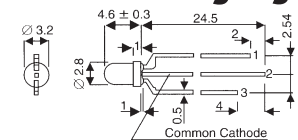

Part No.	Colour	Package	Viewing Angle	Luminous Intensity
L-937 EGW	R/G	2 leads	60°	20/16mcd
L-115 WEGW	R/G	3 leads	60°	40/35mcd
L-115 WSRSGW	R/G	3 leads	60°	150/30mcd

Part No.	Ord. No.
S L-937 EGW	12590
S L-115 WEGW	12551
S L-115 WSRSGW	48708

5mm Bi - Colour Series

Kingbright

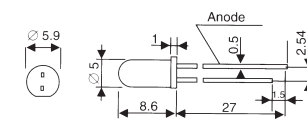
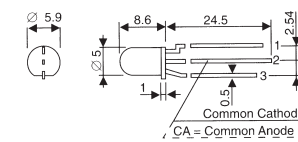

Part No.	Colour	Package	Viewing Angle	Luminous Intensity
L-57 EGW	R/G	2-leads, dif.	60°	30/20mcd
L-59 EGW	R/G	3 leads, dif.	60°	60/50mcd
L-59 EGW/CA	R/G	3 leads, dif.	60°	5/5mcd
L-59 SRSGW	R/G	3 leads, dif.	60°	220/60mcd
L-59 SRSGC	R/G	3 leads, clear	24°	600/200mcd
L-59 EYW	R/Y	3 leads, dif.	60°	60/40mcd
L-59 GYW	G/Y	3 leads, dif.	60°	50/40mcd

CA - common anode

Part No.	Ord. No.
S L-57 EGW	12321
S L-59 EGW	12383
S L-59 EGW/CA*	12120
S L-59 SRSGW	12352
S L-59 SRSGC	11941
S L-59 EYW	12412
S L-59 GYW	11988

8mm Bi - Colour Series

Kingbright

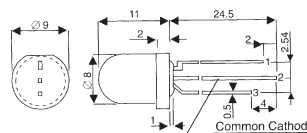

Part No.	Colour	Package	Viewing Angle	Luminous Intensity
L-799 EGW	R/G	3 leads, dif.	50°	80/50mcd

Type	Ord. No.
S L-799 EGW	12320